



BERG PLAYBASE ***Basketball hoop***

User manual

Gebruikshandleiding

Benutzerhandbuch

Manuel d'utilisation

Manual de usuario

Manuale utente

Brugervejledning

Användarmanual

Bruksanvisning

Käyttöopas





20.20.01.00

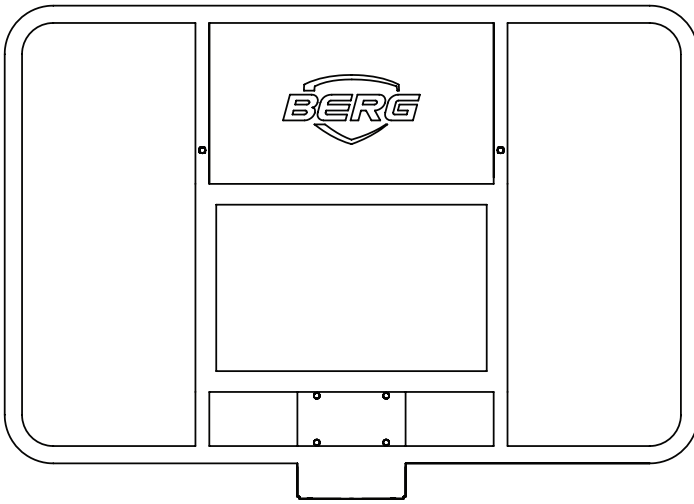

1

1x

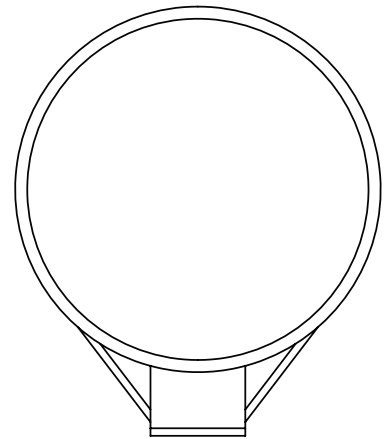

2

1x

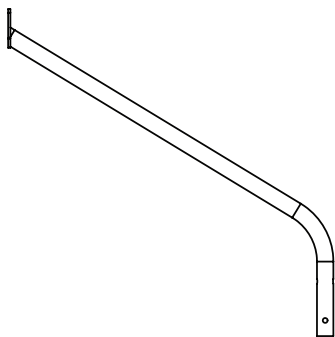

3

2x

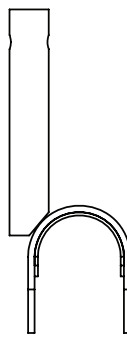

4

2x

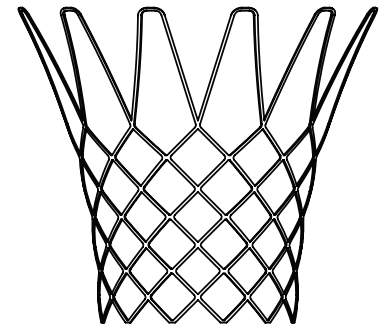

5

1x



6

2x



7

2x

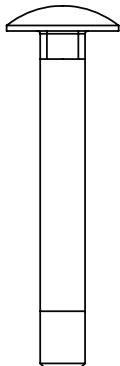

8

2x

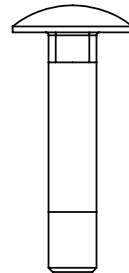

9

2x

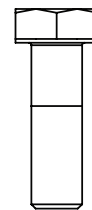

10

4x

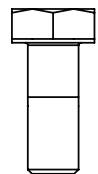

11

4x



12

2x



13

4x

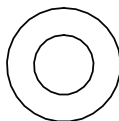

14

16x



15

4x



16

8x



17

2x



1

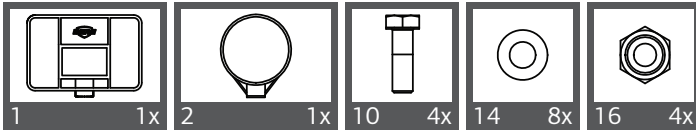
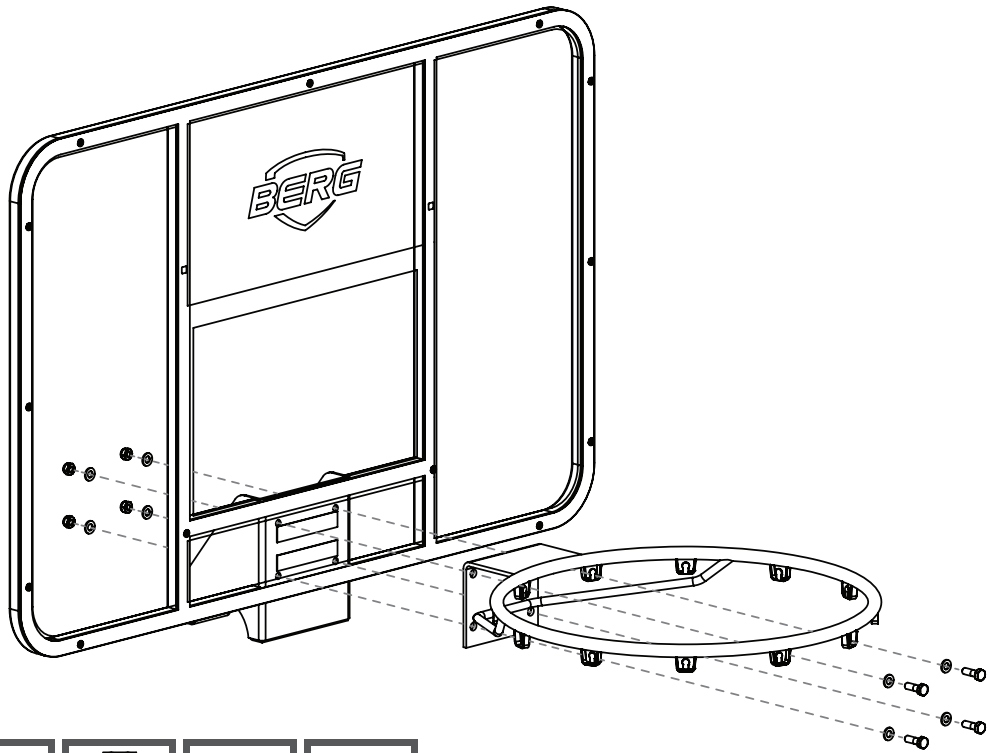

2

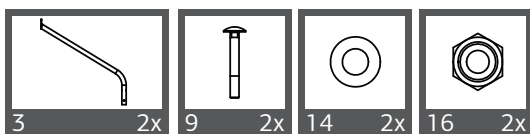
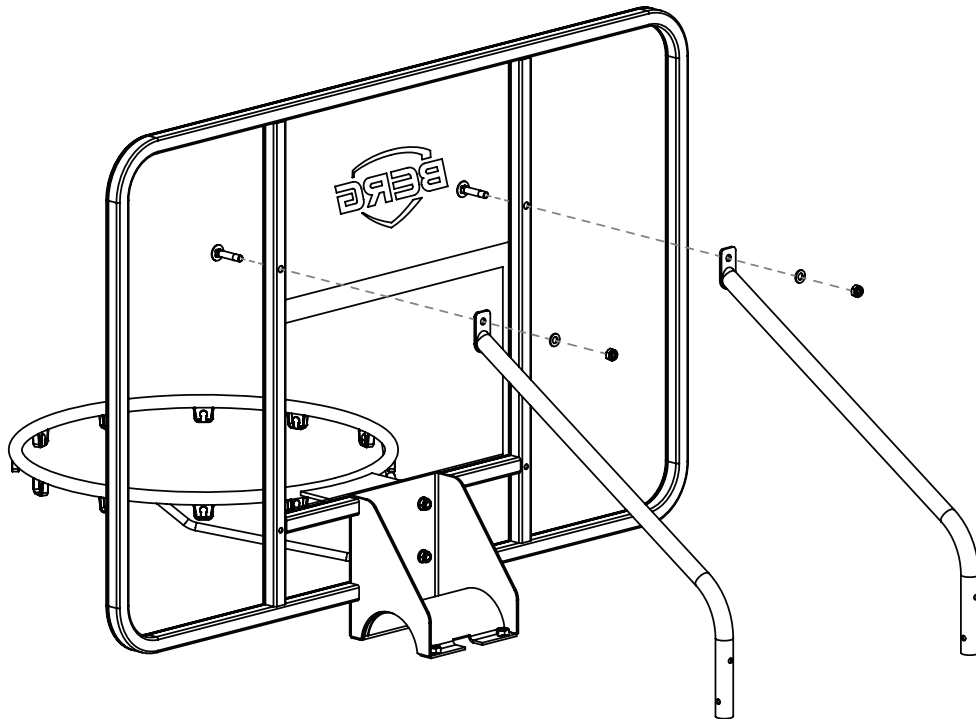

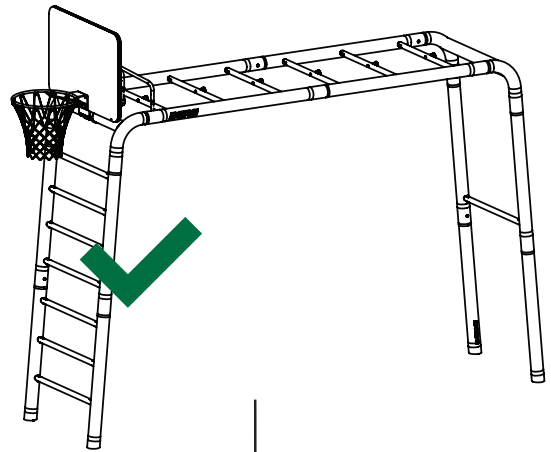
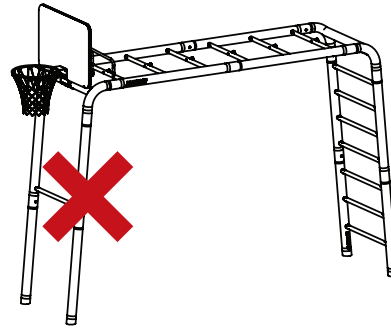
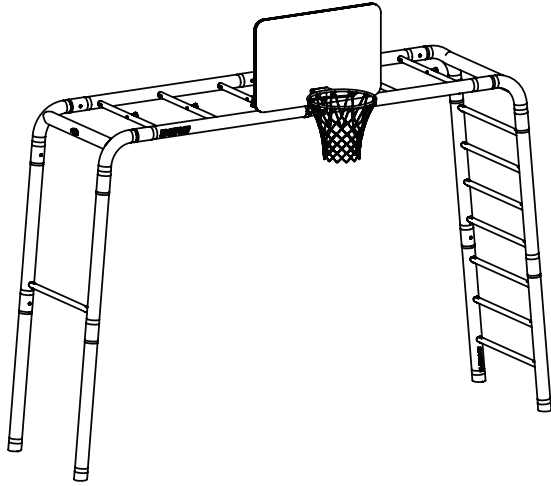

3a

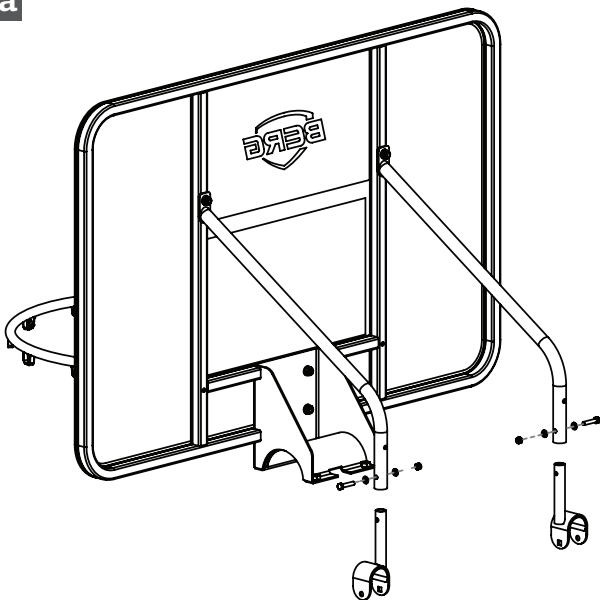

3b

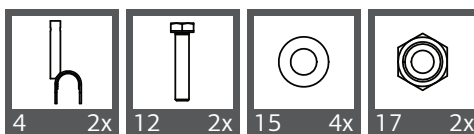
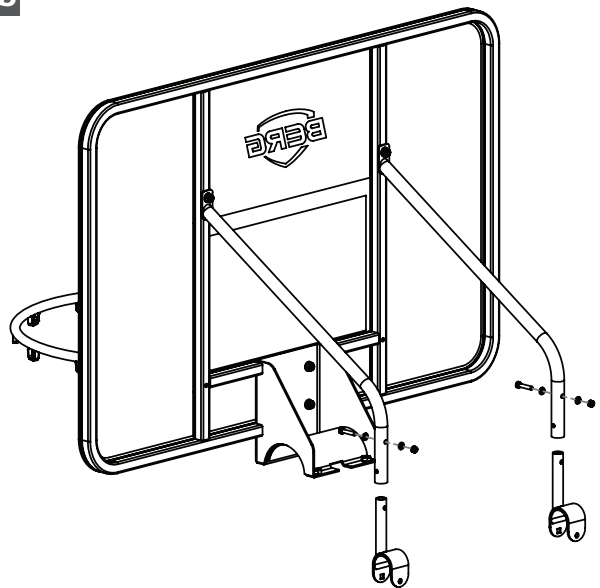

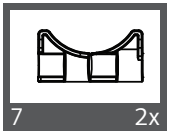
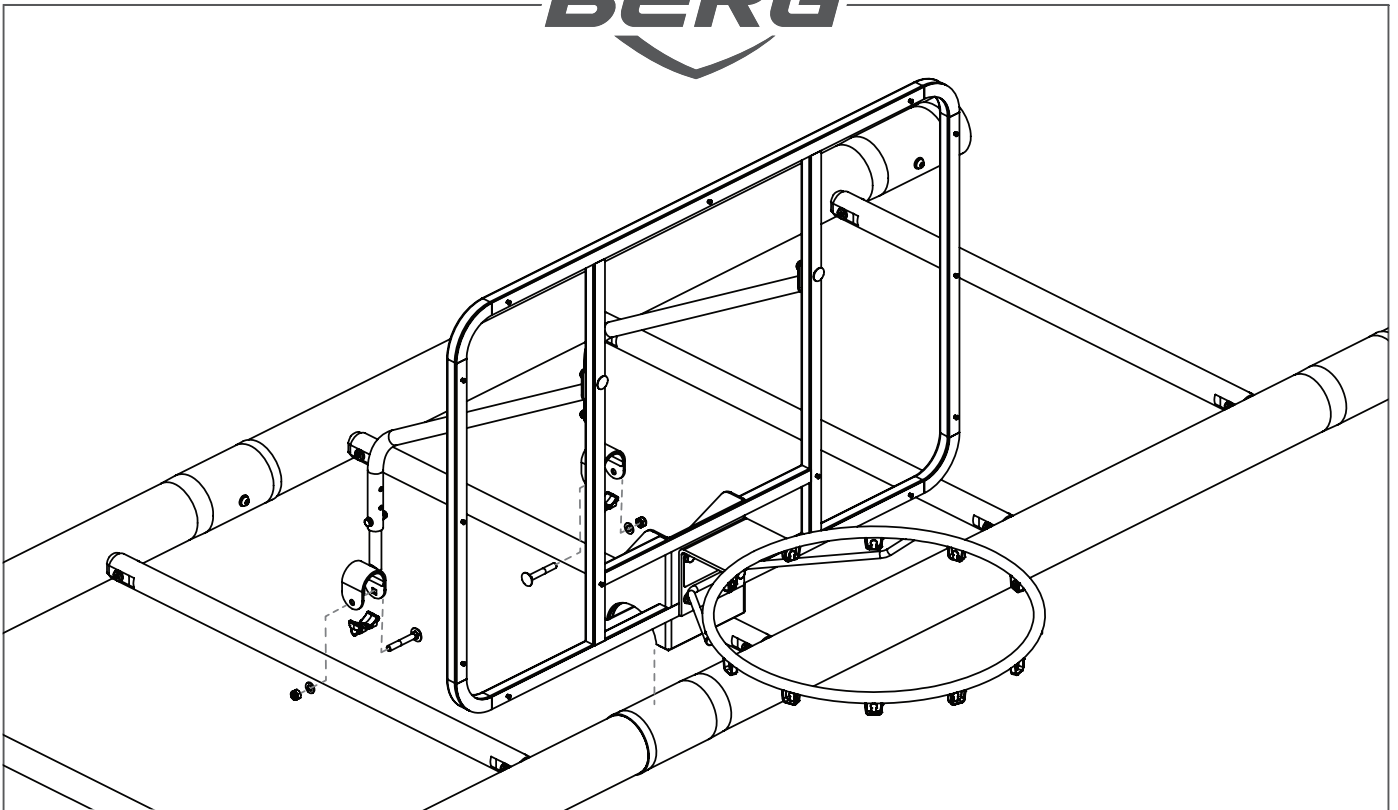

2x

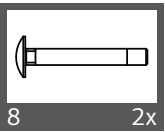

2x

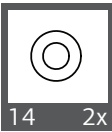

2x



2x

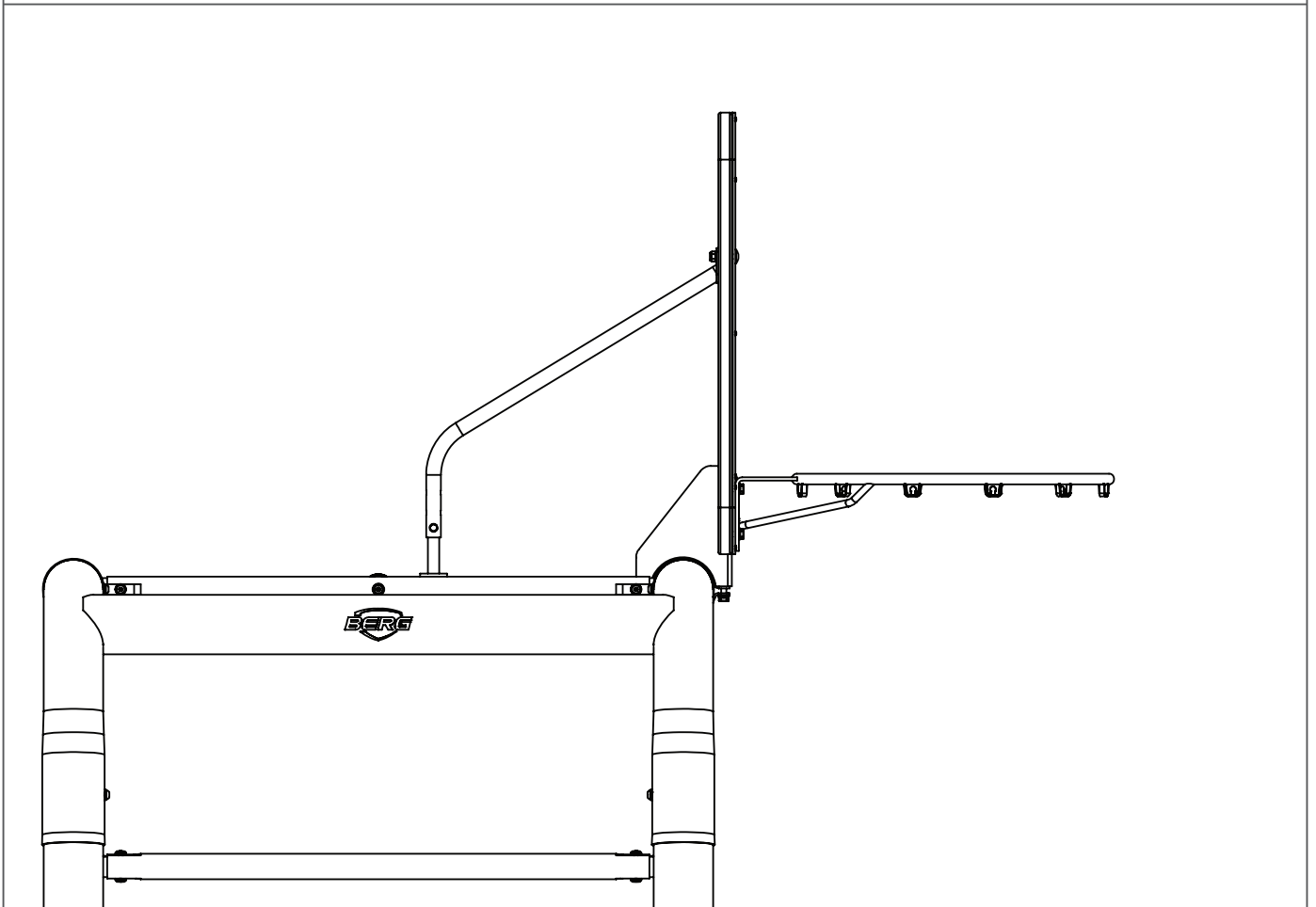

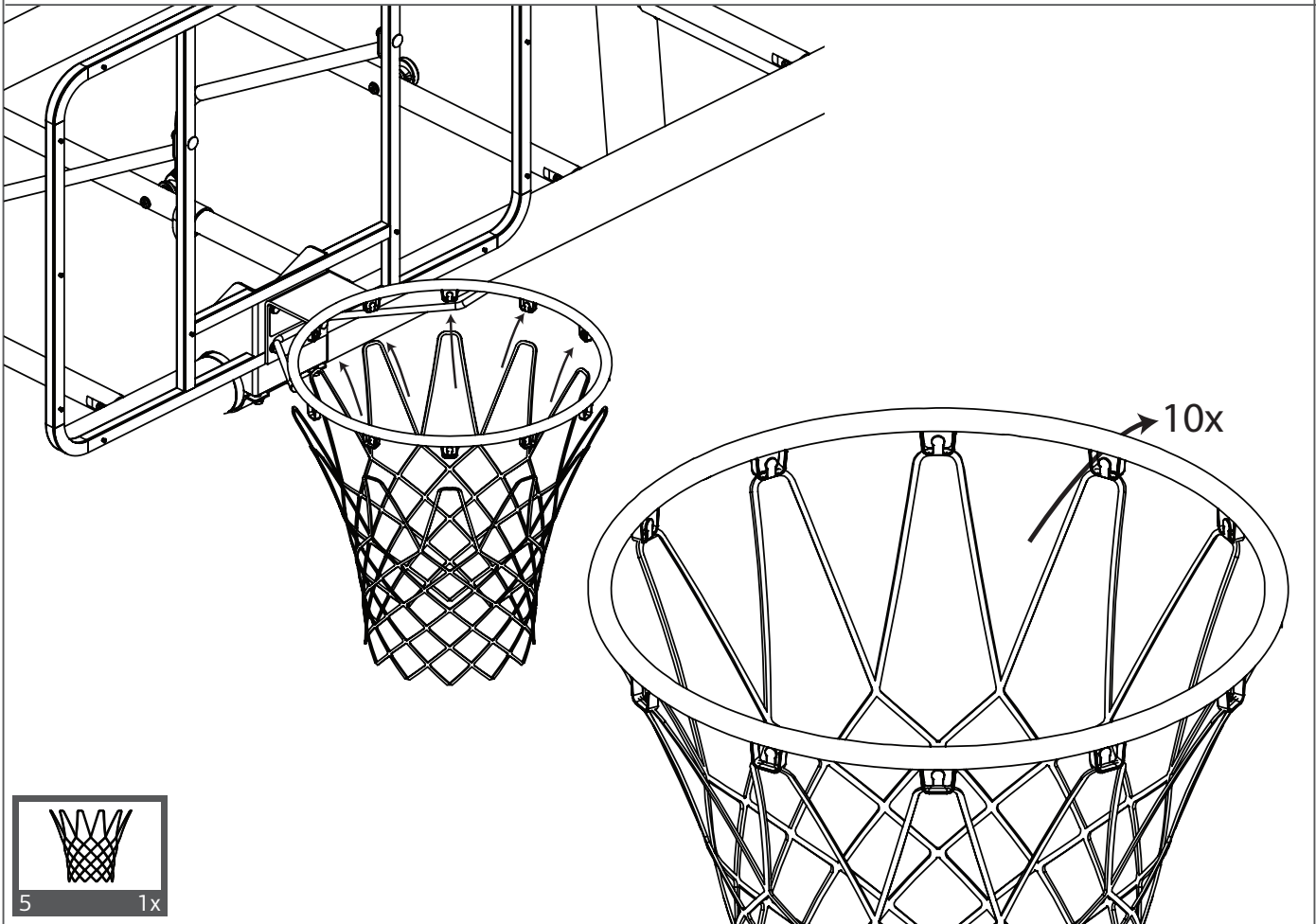
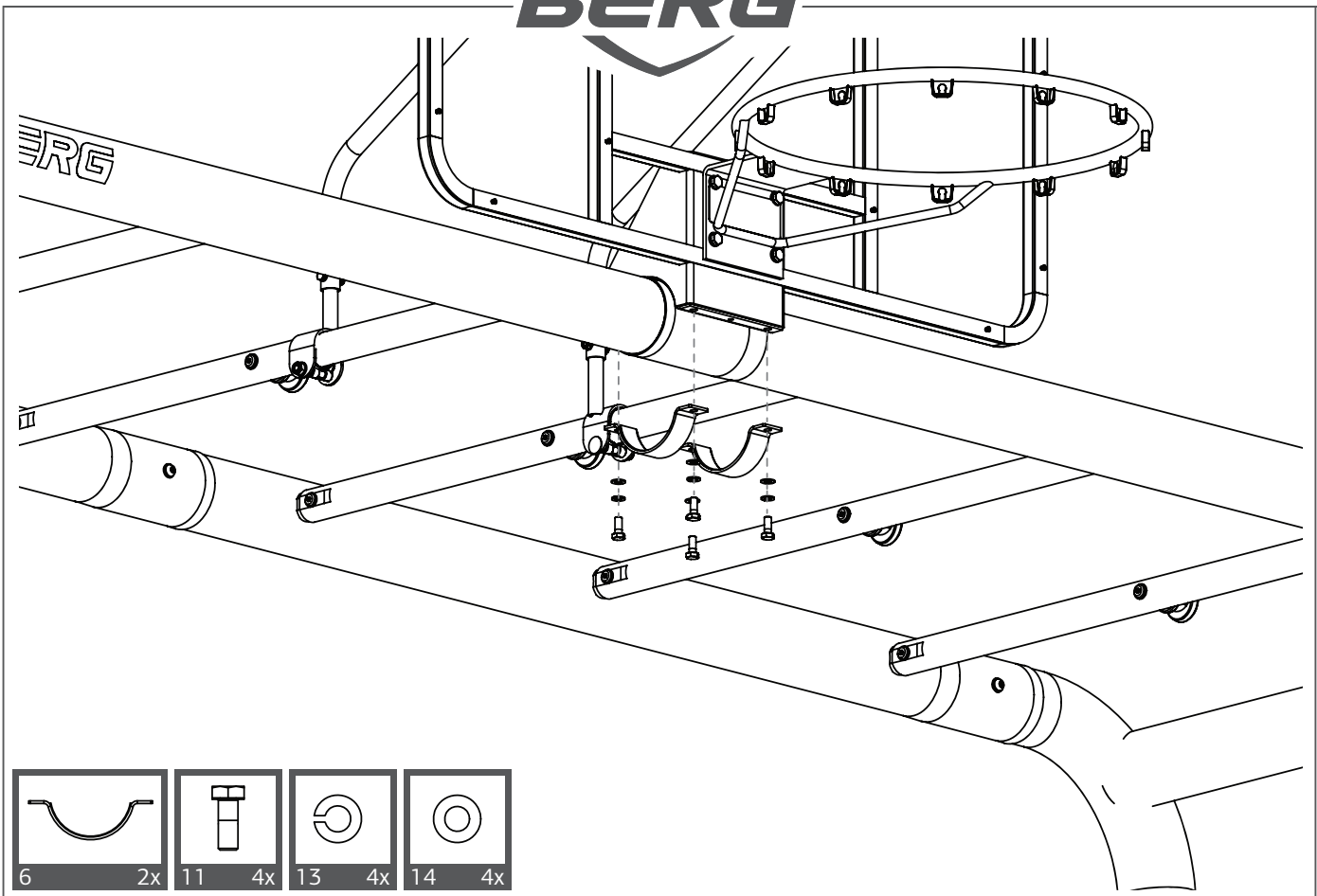



1. Warnings

This accessory is only suitable for assembly on the complete BERG PlayBase frame consisting of the BERG PlayBase topframe (20.10.xx.xx) with 2 side frames (20.11.xx.xx). Always read the BERG PlayBase frame manual in combination with this manual.

- Read instructions prior to first use and keep for future reference!
- Do not hang on the hoop.
- Adult assembly required.
- The maximum user weight is: 50 kg.
- Not suitable for children under 36 months.
- Falling hazard - frame height of 245 cm.
- Choking hazard - small parts.
- Adult supervision required.
- Only for domestic use.
- Only for outdoor use.
- Do not climb on the frame when the Basketball hoop is in use
- For general safety instructions of this accessory in combination with the PlayBase frame see section 2. Safety instruction of the PlayBase frame manual.
- We advise the removal and storage of this product during rain and the winter because the material will wear rapidly and fungus can appear inside the product.
- In case of damage or visible wear of parts the accessory device must not be used and be entirely removed from the activity toy.

2. Inspection and maintenance

To ensure the safety of the users of the product, the product has to be subjected to the safety inspections and maintenance instructions mentioned below. If not carried out regularly the product could become a hazard.

	Before each use	Monthly	Beginning of each season
Suspension points	Check for visible damage	Check if the connections are tight and tighten them if needed	Inspect the frame connections thoroughly
Basketball hoop	Check for visible damage	Check if the connections are tight and tighten them if needed	Check for wear and tear and replace if needed
Netting	Check condition	Check for wear and tear and replace if needed	Check for wear and tear and replace if needed

- Check attachments for evidence of deterioration.
- Replace defective parts in accordance with the manufacturers' instructions.
- Any worn or replaced parts must be disposed according local guidelines. Pay attention to the environment.

3. Warranty

Inappropriate use or faulty application of the product is explicitly forbidden and absolves the manufacturer of all liability. Modifications made by the customer to the original product (for example the adding of an accessory) shall be carried out according the instructions of the manufacturer.

The owner of this BERG product has the following warranty on this product:

- The product has a warranty of 2 years from the date of purchase.
- Parts that are liable to wear and tear (such as the net), the influences of weather (such as rust and discolouration) are excluded from warranty.
- Check www.bergtoys.com for extensive warranty regulations.



BERGTOYS.COM